

Thank you for purchasing our product. Although we do our utmost to prevent defects by carrying out exhaustive inspections, should you find any defect, please contact Komy at info@komy.co.jp. Please note that improper installation may result in the mirror falling off unexpectedly. Please read through the instructions below for proper use.

## How to Use

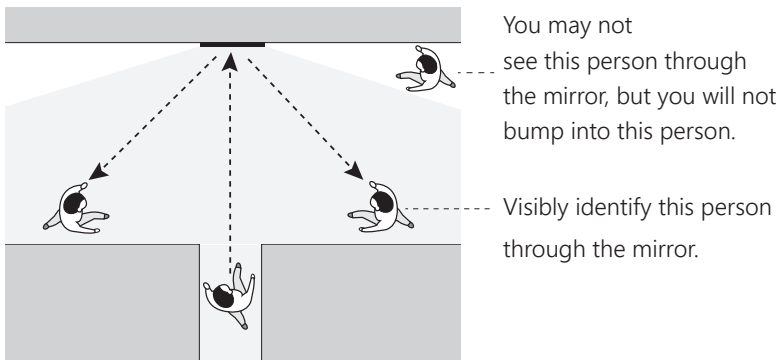

### Emphasize Additional Caution

If you would like to emphasize additional caution to people passing through the corridor, we recommend informational statement stickers and outer markings adopted by safety & hazard products on the market.

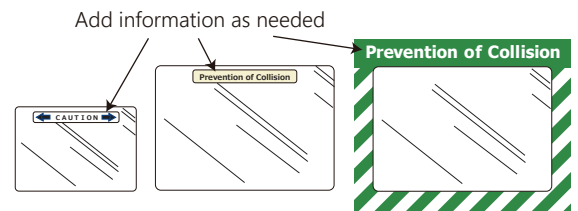

## How to Install

(Use the magnet type in places where a magnet can be affixed.)

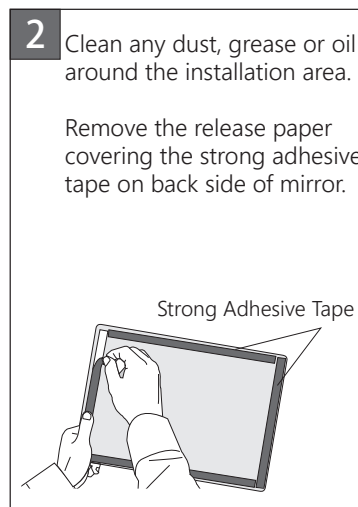
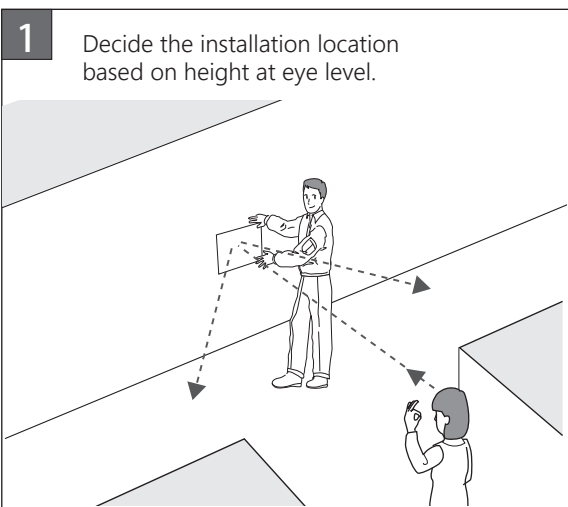

<p><b>Caution</b></p>	<ul style="list-style-type: none"> <li>Do not use in a place exposed to strong ultraviolet rays emitted from germicidal lamps or other sources, nor in a place where oil mist, strong acid, or alkali is generated.</li> <li>Do not use petroleum solvents such as thinner, gasoline, kerosene, and lacquer (otherwise the product loses its function as a mirror).</li> <li>This mirror is weak in water. Water-wet wiping is strictly prohibited.</li> <li>Do not install on sanded wall, walls with ridges and walls that have been coated by chemicals or silicon.</li> </ul>
<p><b>Regular inspections</b></p>	<ul style="list-style-type: none"> <li>Inspect the mirror regularly. Wipe off any dust or dirt with a commercially available glass cleaner.</li> </ul>
<p><b>Characteristics</b> (Points to be aware of)</p>	<ul style="list-style-type: none"> <li>Reflected images may look distorted when viewing the mirror while moving or from a distance.</li> <li>By its nature, KomyMirror may have small scratches that do not affect visibility.</li> <li>Due to its special composition, KomyMirror is inferior in sharpness to a convex mirror. However, this does not affect visibility.</li> <li>In the direct rays of the sun or other light sources, the mirror may be difficult to look at depending on the angle.</li> </ul>

**Caution** Failure to follow a caution indicated by this symbol and mishandling may result in personal injury or only property damage.