

Thank you for purchasing our product. Although we do our utmost to prevent defects by carrying out exhaustive inspections, should you find any defect, please contact Komy at komy-gf@komy.co.jp. Please note that improper installation may result in the mirror falling off unexpectedly. Please read through the instructions below for proper use.

How to Use

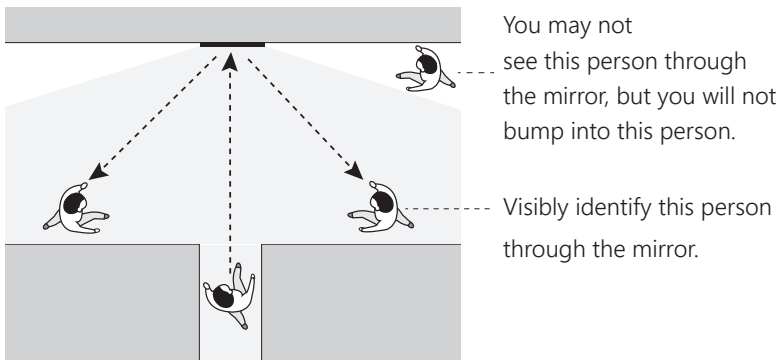

Emphasize Additional Caution

If you would like to emphasize additional caution to people passing through the corridor, we recommend informational statement stickers and outer markings adopted by safety & hazard products on the market.

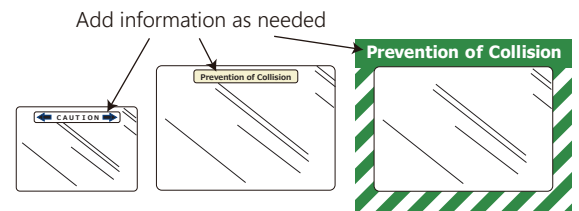

How to Install

(Use the magnet type in places where a magnet can be affixed.)

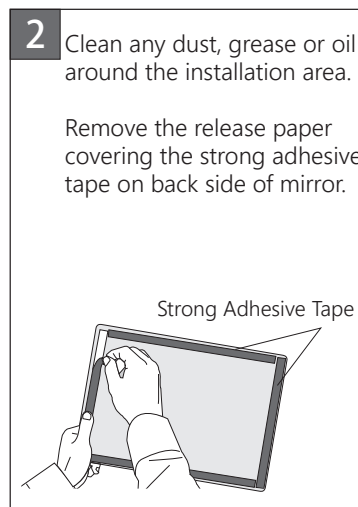
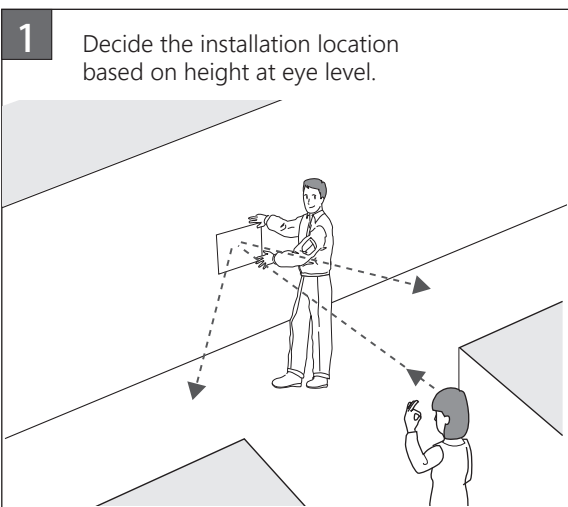

<p>Caution</p>	<ul style="list-style-type: none"> Do not use in a place exposed to strong ultraviolet rays emitted from germicidal lamps or other sources, nor in a place where oil mist, strong acid, or alkali is generated. Do not use petroleum solvents such as thinner, gasoline, kerosene, and lacquer (otherwise the product loses its function as a mirror). This mirror is weak in water. Water-wet wiping is strictly prohibited. Do not install on sanded wall, walls with ridges and walls that have been coated by chemicals or silicon.
<p>Regular inspections</p>	<ul style="list-style-type: none"> Inspect the mirror regularly. Wipe off any dust or dirt with a commercially available glass cleaner.
<p>Characteristics (Points to be aware of)</p>	<ul style="list-style-type: none"> Reflected images may look distorted when viewing the mirror while moving or from a distance. By its nature, KomyMirror may have small scratches that do not affect visibility. Due to its special composition, KomyMirror is inferior in sharpness to a convex mirror. However, this does not affect visibility. In the direct rays of the sun or other light sources, the mirror may be difficult to look at depending on the angle.

Caution Failure to follow a caution indicated by this symbol and mishandling may result in personal injury or only property damage.